

NOTE: EXTREME CARE MUST BE EXERCISED TO ENSURE THAT THE OUTLET HOLES IN THE STANDPIPE DO NOT BECOME CLOGGED WITH SEDIMENT DURING CONSTRUCTION

PLAN VIEW

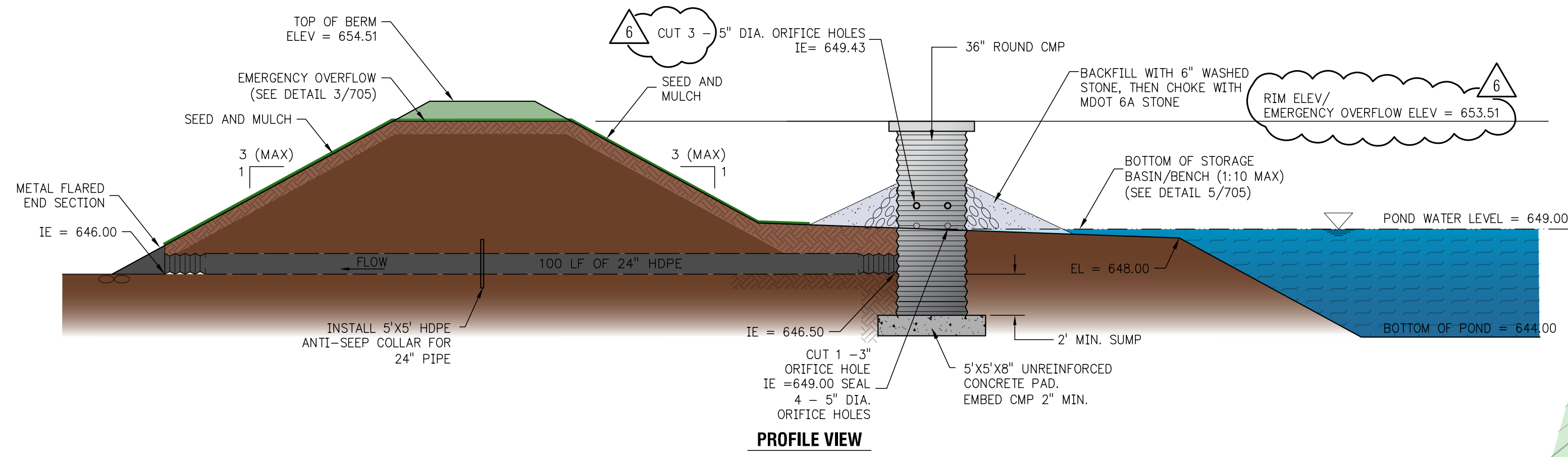

1
C313

BASIN #2 SLOW RELEASE DETAIL

NO SCALE

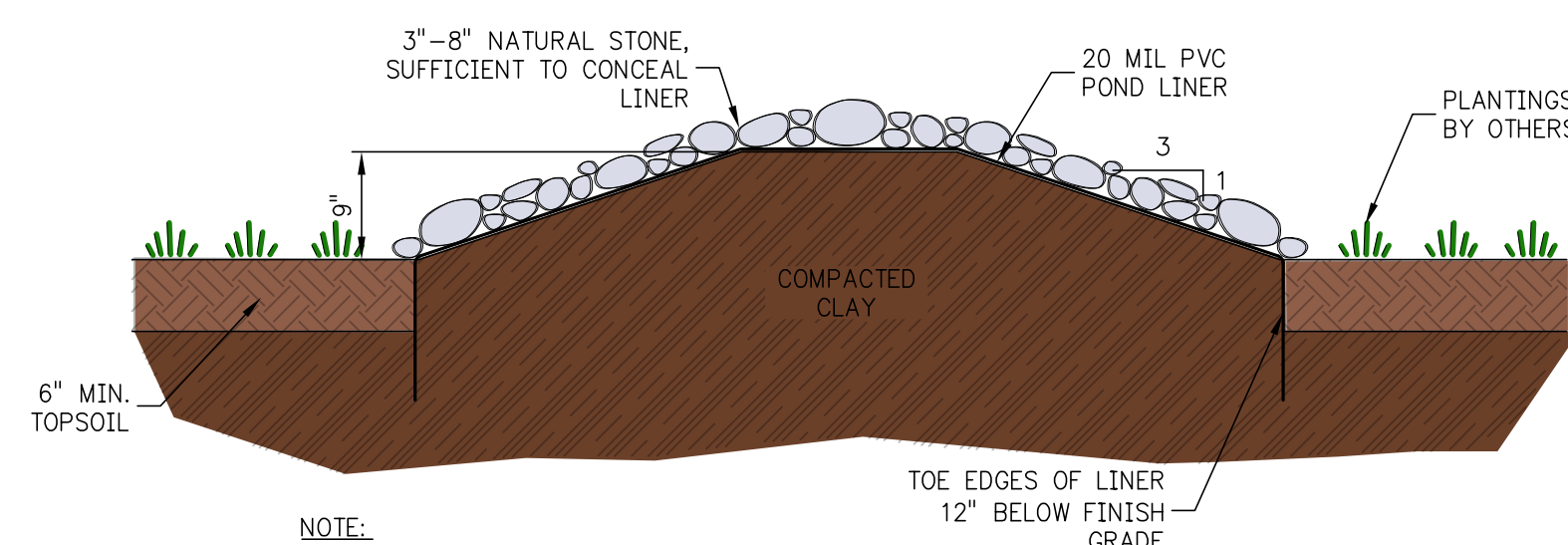

OVERFLOW BERM DETAIL

NO SCALE

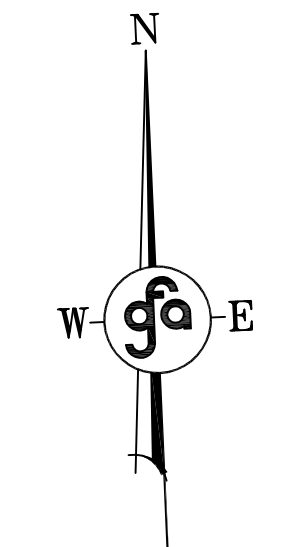
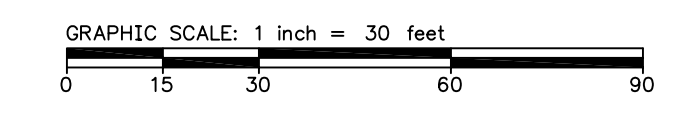

GENERAL NOTES
1. REFER TO SHEET C100 FOR BENCHMARK INFORMATION.

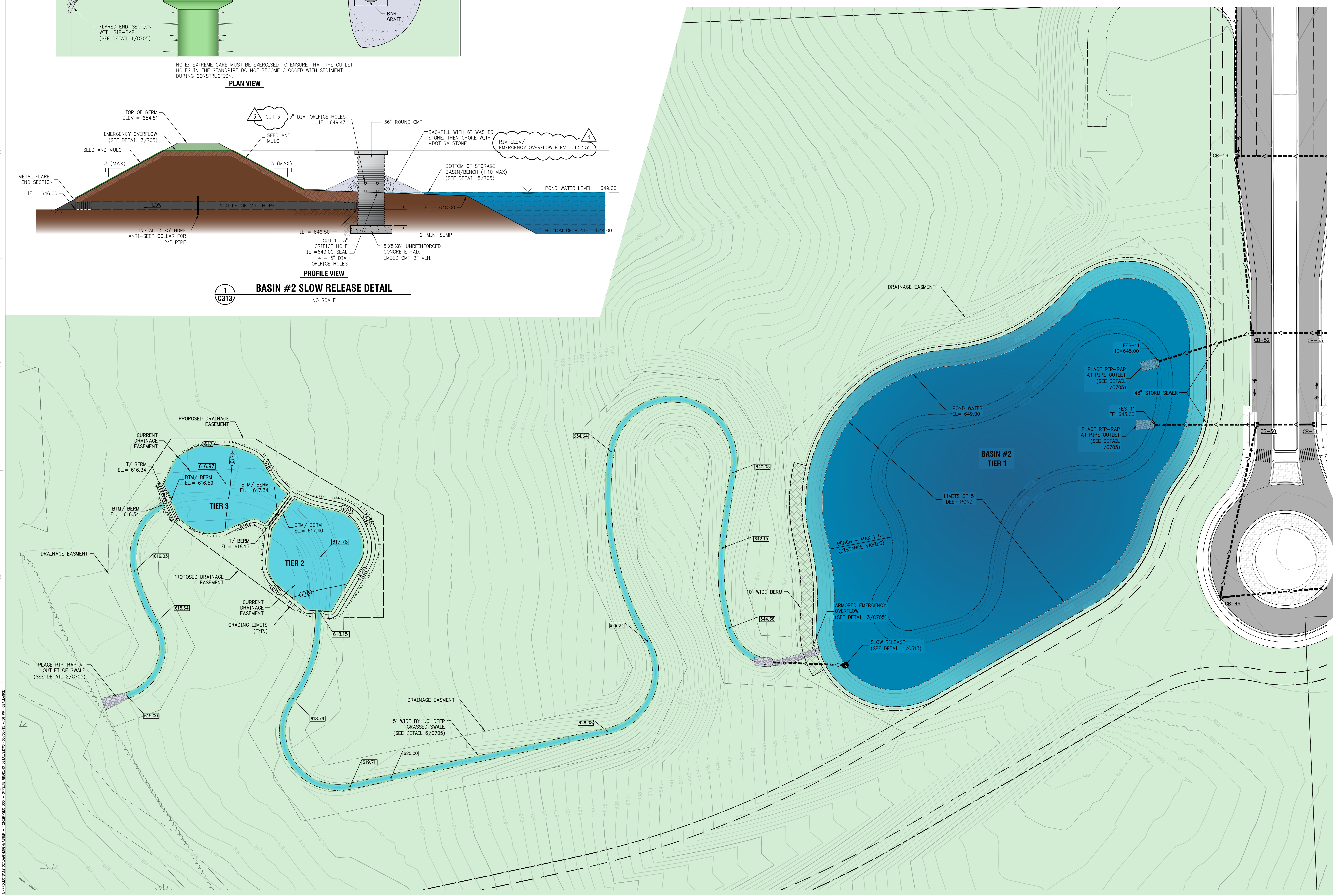

GRAND TRAVERSE TOWN CENTER

ACME TOWNSHIP, GRAND TRAVERSE COUNTY, MI

VILLAGE AT GRAND TRAVERSE, LLC
CINCINNATI, OH 45209-1955
3805 EDWARDS ROAD, SUITE 700
(513) 241-5800

REVISION NO.	REVISION	REV. DATE
4	SLOW RELEASE REVISIONS	02/27/2015
5	GC REVIEW COMMENTS	04/15/2015
6	CONSING CZUBAK REV.	05/05/2015
3	SLOW RELEASE REVISIONS	02/25/2015

CONSTRUCTION MANAGED BY:

DESIGNED BY:
go Gourdie-Fraser
Municipal | Development | Transportation
123 W. Ford Street, Troy, MI 48064
Phone: (313) 946-9874, Fax: (313) 946-3703

BASIN #2 DETAIL

DRAWN BY	ISSUE	ISSUE DATE	SHEET NO.
TGR			C313
CHECKED BY	MANAGER	GFA PROJECT NO.	GFA PROJECT NO.
TLMB	T. BOYD P.E.	12102	